

# MEDLEY XL

## INSTALLATION & MAINTENANCE INSTRUCTIONS | LUXURY VINYL

**PLEASE READ ALL INSTRUCTIONS CAREFULLY, BEFORE YOU BEGIN INSTALLATION.  
IMPROPER INSTALLATION WILL VOID WARRANTY.**

Thank you for purchasing Medley XL Luxury Vinyl Flooring! These instructions for the installation and care and maintenance of your floor will help you enjoy your new flooring for many years to come.

### **BEFORE YOU START**

- Always check panels for defects such as chips and color or sheen differences under well-lit conditions.
- Check that the click channel is clean and free of debris.
- Always work out of multiple boxes to mix product to achieve proper pattern repeat and color appearance.
- If the appearance of a board is questionable for either dimensions or appearance, the installer should not use the board piece. A replacement carton can be obtained through your dealer.

*NOTE: This Premium Waterproof Polymer Core (PPC) LVP can be installed above, on and below grade. The product may be installed either as a floating floor or by direct glue down method on approved wood or concrete subfloors. Direct glue down applications require a full spread adhesive such as WF Taylor 2098 OR WF Taylor 2091 or equivalent. Follow the manufacturer's installation instructions when doing a glue down installation.*

Walls, subfloors, and installed floors in buildings and houses move. It is recommended that a 1/4" gap for expansion is left between the flooring and any adjacent perimeter wall, vertical structure, or wood-based floor (laminated or hardwood).

### **SUBFLOOR PREPARATION**

Engineered Vinyl Click (EVC) with PPC is a waterproof product. Moisture will not damage the product. When installed, it does not produce a moisture barrier nor does it protect the walls or structure of the home. Only installing a moisture barrier in a crawl space or under the PPC LVP over a concrete floor can ensure this. Please see the below Subfloor Requirements section for moisture limits to protect the home from moisture damage.

### **JOBSITE PREPARATION BEFORE INSTALLATION**

The responsibility for installation of the floor is with the local job site installer. All product must be inspected prior to installation for color variation, finish condition, sheen variation, and quality. This inspection should be conducted with proper lighting available. Any boards that are not acceptable **SHOULD NOT BE INSTALLED**. Contact your dealer immediately to obtain replacement boards. The Manufacturer is not responsible for the installation of flooring with obvious defects.

It is the responsibility of the local job installer to ensure that the jobsite and subfloor meet the requirements of these installation instructions. The Manufacturer is not responsible for failure of this product caused by unsatisfactory jobsite and/or subfloor conditions.

Minimum crawl spaces of 18" are required from the ground to the underside of the joists. A vapor barrier of 6-20 mil thick polyethylene film with 6" sealed lap joints is needed. Moisture resistant tape should be used as the vapor barrier sealant at the lap joints. Venting for the crawl space should be at least 1.5% of the crawl space square footage. Vents should be located for cross-ventilation of the crawl space. Local regulations should prevail at all times.

Before floor installation, the room conditions in the installation area (temperature and moisture) should be at normal year-round conditions for at least one week prior to and during flooring installation. Recommended installation room conditions are temperatures between 65°-85°F and relative humidity between 35-55%. Never install below 45°F or above 105°F.

Acclimate the flooring to the conditions above for at least 48 hours prior to the beginning of the installation process.

### **SUBFLOOR REQUIREMENTS**

All subfloors must be dry, structurally sound to support the floor, free of debris and foreign matter, and flat to 3/16" in a 10 foot radius.

For concrete floors, the subfloor should be firm, flat, dry, and clean. This includes both old and new concrete floors. New concrete slabs must cure in well-ventilated conditions for at least 60 days minimum before installing the floor. Concrete should have a minimum 6mil polyfilm moisture barrier between the concrete and ground. Maximum moisture level per the Calcium Chloride test method is 8lbs. per

1000 ft in 24 hours. The maximum level of relative humidity per ASTM 2170 test method is 85%.

Subfloors must be dry and properly secured to accept a top floor. The subfloor must be secured every 6" along joists with nails or screws to avoid squeaking. The floor must be leveled. High spots must be ground down and low spots must be filled with a Portland cement leveling compound.

**Please Note: Medley XL is not approved for installation over any type of carpet.**

**NOTE: Never install Medley XL over any type of floating floor. All subfloors that are not concrete must be firmly bonded.**

**NOTE: Never install Medley XL over a below grade VCT (vinyl composition tile).**

Tiles including ceramic, resilient, and sheet vinyl must be well bonded to the subfloor, must be level, and must be clean. Existing vinyl floors should not be sanded as they may contain asbestos.

**\*\*Please note: Medley XL Luxury Vinyl comes with an attached cushion. No additional foam is required or recommended.\*\***

#### **APPROVED SUBFLOOR TYPES**

CDX Underlayment Grade Plywood (minimum of 5/8" thickness)	Concrete Slab
Underlayment Grade Particleboard (only for floating installation)	Ceramic Tile
OSB (minimum 3/4", 23/32" thickness)	Resilient Tile - one layer well bonded
Laminate - one layer glued down and well bonded	Sheet Vinyl - one layer well bonded
Wood - one layer glued, nailed, or screwed down, well bonded	

#### **INSTALLATION TOOLS**

1/4" spacers	Rubber mallet
Aqua-Lok tapping block	Utility knife
Pull bar	Pencil
Saw	Tape Measure
Ruler	Construction Adhesive

**NOTE: The Aqua-Lok tapping block was specially designed for installing this product with an Angle & Tap joint and must be used in the installation to lightly tap the planks together to validate the product warranty.**

#### **BASIC INSTALLATION**

While EVC with PPC LVP is dimensionally stable, buildings, walls, and existing hardwood and laminate floors will expand and contract. Because of this, we recommend for all installations, both floating floor and glue down types, that an expansion gap of 1/4" be left for expansion between any vertical surface, an adjacent perimeter wall or wood-based floor (laminate or hardwood).

As stated earlier, always work out of multiple boxes to mix product to achieve proper pattern repeat and color mix for the look of natural wood. Inspect each plank or tile in good light for visual defects. If they show visual faults or damage, do not install them. It is the responsibility of the installer to ensure that the appearance of the finished floor meets the consumer's expectations.

Medley XL is an indoor product. It will not be warranted when installed in locations or conditions not recommended for this product.

1. Remove the tongue on the side of the panels that face the wall. This is to ensure that the decorative surface of the floor is well under the finished trim when installed. Use a utility knife to score through the tongue several times until it easily snaps off.
2. Start in a corner by placing the first panel with its trimmed side facing the wall. Use space along each wall to maintain an expansion space of 1/4" between the wall and the flooring. *Diagram 1.*
3. To attach the second panel, insert the end tongue of the panel into the end groove of the first panel at a 20° angle. Lower the panel flat to the floor. Line up the edges carefully. *Diagram 2.*
4. Continue connecting the first row until you reach the last full panel. Fit the last panel by rotating the panel 180° with the pattern side upward, place it beside the row, and mark it. *Diagram 3.*
5. Saw off the excess plank. Attach as described above. *Diagram 4.*
6. Begin the next row with the off cut piece from the previous row to stagger the pattern. Pieces should be a minimum of 8" long and joint offset should be at least 8". *Diagram 5.*
7. Start the second row by pushing the side tongue of the panel into the side groove of the very first panel at about a 20° angle. When

lowered, the plank will click into place. *Diagram 6.*

8. Attach the second panel of the new row on the long side as described above. Push this panel as close as possible to the previous row. To attach this second panel to the previous panel, lightly tap the end using the Aqua-Lok tapping block and rubber mallet. Continue along in the same fashion. *Diagram 7/8.*

9. To fit the last row, lay a panel on top of the previous row. With the tongue to the wall, lay another panel upside down on the one to be measured and use it as a ruler. Don't forget to allow room for 1/4" spacers. Cut the panel and attach it into position. *Diagram 9.*

10. Door frames and heating vents also require expansion room. First cut the panel to the correct length. Then place the cut panel next to its actual position and use a ruler to measure the areas to be cut out and mark them. Cut out the marked points allowing the necessary expansion distance on each side. *Diagram 10.*

11. Door frames can be trimmed by turning a panel upside down and using a handsaw to cut away the necessary height so that panels slide easily under the frames. *Diagram 11.*

### **INSTALLING UNDER A DOOR JAMB**

Installation under door jambs may require that the top of the groove be reduced in size.

- Using a small plane, chisel or knife shave off the ledge of the groove.
- Place a bead of glue on the bottom lip of the groove then set the board in place and tighten with a pull bar.
- Insert the tongue into the groove and engage with a pull bar. Hold the board in place with 3M Scotch-Blue™ 2080 Tape only as all other tape may damage the finish of the flooring.
- Remove the spacers and you are ready to install finishing molding.

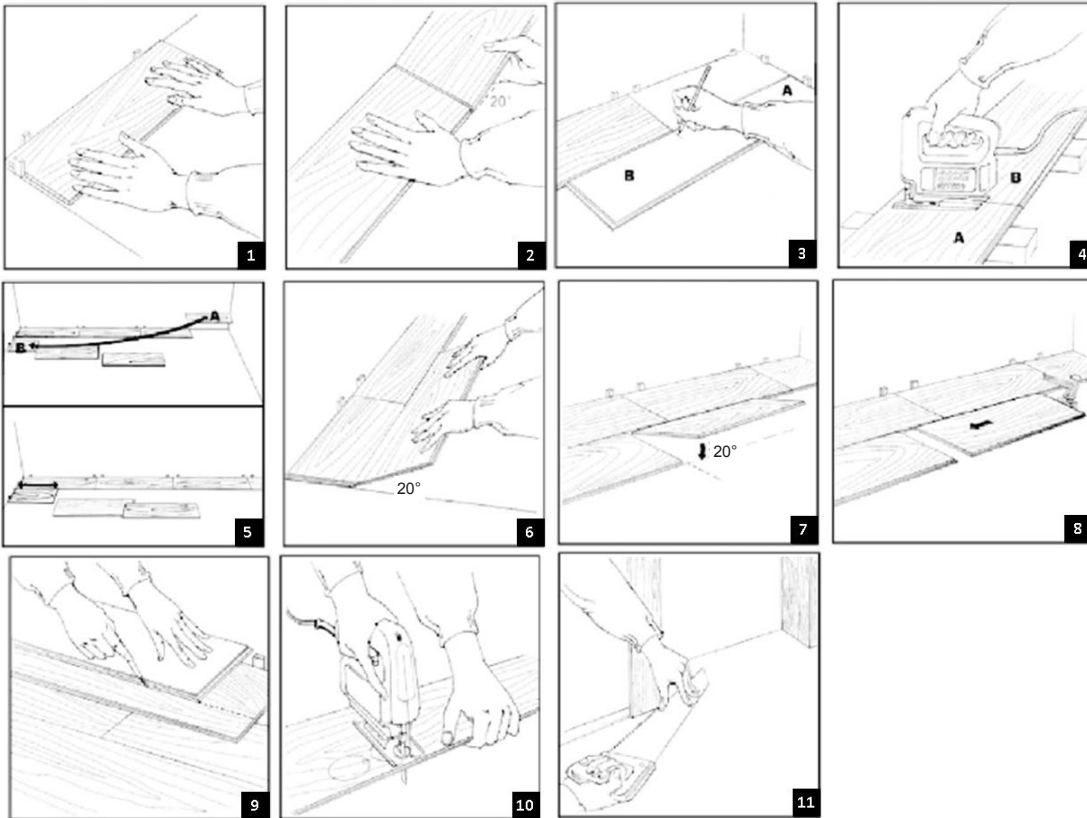

***IMPORTANT ENVIRONMENT CONDITIONS: \*Installation of flooring in areas of prolonged direct sunlight can cause plank discoloration and plank expansion. It is recommended that appropriate window coverings be used in these areas.\****

### **FINISHING MOLDING**

- Reducer molding is used to finish flooring when the adjoining surface is lower than the extruded composite LVT flooring or when flooring meets carpet. Position the U-track 1.4" between each edge of the flooring. Screw, nail or glue down the track directly to the subfloor and then insert the reducing strip into the track.
- T-molding is used to finish flooring when two level surfaces meet in doorways. Install same as above. Residential installations do not require the use of T-moldings.

- Commercial installations will require the use of t-moldings in all doorways and anywhere the flooring continues from one room into another room.
- Landing molding is used to finish flooring on landings or stair edges. Moldings need to be glued and screwed down to the sub-floor for safety and stability. Color fill should be used to cover counter sunk screws.
- To finish the perimeter of the room, install quarter round molding using finishing nails. Quarter round molding is nailed directly into the baseboard.

### **RADIANT HEATED FLOORS**

Medley XL can be installed over certain types of radiant heated floors either as a floating floor or glued down. Direct glue down applications require a full spread adhesive such as WF Taylor 2098 or WF Taylor 2091 or equivalent. Follow the manufacturer's installation instructions when doing a glue down installation.

When installing over a radiant heated floor:

- Newly installed radiant heated floors must be operational for at least (4) weeks prior to Medley XL installation with the temperature set between 55°F and 85°F to ensure that the subfloor has been dried.
- Existing radiant heated floors should be set to a minimum temperature of 65°F for a minimum of 4 days before, during and 48 hours after the completion of the installation. This will insure that the floor will acclimate properly before the installation begins. Upon completion of the installation, gradually increase the temperature in increments of 5°F per hour until desired temperature is achieved. Never exceed 85°F.
- Wood subfloors should never exceed 10% moisture content as measured by a calibrated wood moisture meter.
- Concrete subfloors must be "dry" using the mat test, a calibrated concrete moisture meter, Calcium Chloride Test or a RH Probe.
- Ground floors using the radiant heating system should have a proper moisture barrier beneath it.
- The recommended range of relative humidity is 35%-55% and the room temperature should be between 55°-85°F for the delivery of the flooring, acclimation, and installation.
- Medley XL must acclimate at the stated temperature range for at least 48 hours prior to installation in the room to be installed.
- Keeping the temperature of the room constant will keep a stable environment for the flooring as well as the home.
- The floor surface temperature must always stay below 85°F.
- At no time should the relative humidity in the room with the installed flooring fall below 30% during the life of the product.

*NOTE: Electrically heated radiant mats not embedded in the subfloor and installed directly under this floor are not recommended for use beneath this product. The installation of electrically heated radiant floor heating mats could void the warranty of the installed floor in case of a heating system failure.*

- Failure to strictly follow the adhesive manufacturer's installation directions may result in failure and voiding of the warranty.

### **CARE AND MAINTENANCE**

- Once the floor has been installed, vacuum or use a dust mop to clear the floor of any loose dirt or residual dust or debris. The floor can be wiped with neutral pH cleaners or water.
- Furniture should have felt pads attached to the feet to avoid scratching the floor. Heavy appliances or furniture should sit on non-staining large surface flooring protectors. When furniture has casters or wheels on the feet, they must be suitable for resilient floors, large surface non-staining, and swivel easily. Do not use ball-type casters because they can damage the floor.
- Office chairs with caster wheels should be equipped with wide, rubber casters and protective mats under the chairs.
- Protective mats should be non-staining as rubber mats may discolor the floor. All furniture pieces should have floor protectors under them.
- Walk-off mats should be used in entrances to help prevent dirt from being carried onto the floor.
- The product should never be exposed to temperatures exceeding 100°F. Avoid exposure to long periods of direct sunlight. Blinds or drapes should be closed during peak daylight. Exposure to excessive heat and light can thermally degrade the floor.
- Regularly sweep or vacuum the floor to remove dirt and dust. Do not use a vacuum with a beater bar to vacuum the floor as this can cause floor scratches.
- Do not use hard bottomed electric brooms without padding as they can scratch the floor.
- The Manufacturer does not recommend the use of any type of steam cleaner on Medley XL floors. The concern with these types

of cleaners is that they generate too much moisture and heat. There have been instances where peaked and swelled edges occur. Therefore all complaints that are determined to be from a consumer using a steamer will be denied by The Manufacturer.

- If pet urine contacts the floor, it should be cleaned in a timely manner. If the floor is not cleaned and the urine removed, it may dull the finish.
- Liquid spills and any wet areas should be wiped up and cleaned immediately. The floor can be damp mopped with clean warm water and a dilute floor cleaner as needed.
- Do not use harsh cleaners or chemicals, abrasive scrubbing pads, abrasive tools, or abrasive cleaners as they can scratch the floor.
- Do not use detergents and do not use floor shining products like “mop and shine” types on the floor.
- Petroleum-based products can stain the surface of your vinyl floor. These include materials like asphalt drive way sealer and engine motor oil, among others.

**RECOMMENDED SPRAY CLEANER: FreshFloors by WF Taylor**

***Contact your flooring retailer with questions or concerns regarding your flooring purchase.***