

INSTALLATION & MAINTENANCE INSTRUCTIONS | FLOATING MULTI-LAYER VINYL



PLEASE READ ALL INSTRUCTIONS CAREFULLY, BEFORE YOU BEGIN INSTALLATION.
IMPROPER INSTALLATION WILL VOID WARRANTY. FOR ALL INSTALLATION CONDITIONS AND INFORMATION NOT COVERED SPECIFICALLY UNDER THESE INSTRUCTIONS, OR DEFECTIVE MATERIAL, CONTACT TAS FLOORING.

Always check www.tasflooring.com for the latest installation information, warranty and maintenance information. The instructions for this product can be found by searching for Tandem Rigid. Read and follow all manufacturer instructions.

Please Note: Floating floors are designed to expand and contract monolithically without restriction.

Special attention needs to be given to (but not limited to):

- Avoid excessive heat, such as sunrooms and areas with extended direct sunlight. Excessive heat can cause uneven expansion and contraction and result in floors buckling. Window coverings can be installed to reduce excessive heat.
- Do not apply baseboard too tight to the flooring, or nailing through the flooring, resulting in restricted movement.
- Do not restrict movement by installing cabinets, islands or other heavy objects on top of the flooring. Heavy objects such as pool tables and refrigerators are acceptable as long as they do not exceed 300 PSI onto the floor.
- All subfloors must be smooth and flat, void of waxes or other contaminants that might allow the flooring to stick to the subfloor surface, restricting movement.
- Always allow proper expansion space. An expansion gap must be provided, continuously, at all vertical surfaces, allowing material to expand and contract with no restriction.
- Floors that are restricted from freely expanding and contracting are subject to buckles and gaps. Buckling and gapping due to restricted movement is not covered under warranty.

IMPORTANT: This product comes with an attached cushion, no additional cushion is required or approved.

THE USE OF AN ADDITIONAL CUSHION WILL VOID ALL WARRANTIES.

General Guidelines

Always check www.tasflooring.com for the latest installation information, warranty and maintenance information. The instructions for this product can be found by searching for Tandem Rigid. Read and follow all manufacturer instructions.

Always read the complete installation instructions prior to installation.

Always follow all Local and Federal Building Codes.

Always follow all OSHA regulations for safety.

Although this product is waterproof, it is not a moisture barrier.

Installation Tools Required

1/4" Spacers	Utility Knife	String Line
Rubber Mallet	Tape Measure	Square
Hand Saw, Circular Saw, Jig Saw	Pencil	Pull/Pry Bar

Table Of Contents

1) Pre-Installation Checklist	6) Subfloor Flatness Requirements	11) Trim
2) Installer Responsibilities	7) Subfloor Construction Requirements	12) Installing on Stairs
3) Suitability of Product	8) Radiant Heated Floors	13) Installation Instructions
4) Site Condition Requirements	9) Layout	14) Floor Protection
5) Acclimation Requirements	10) Expansion Space and Transition Trim	15) Maintenance

1) Pre-Installation Checklist

1) NORMAL ROOM CONDITIONS (NRC): Normal room conditions are defined as: ambient air temperature between 65-75 degrees Fahrenheit, surface temperature between 65-75 degrees Fahrenheit, ambient RH (Relative Humidity) between 35%-60%. Flooring should be the last material installed on a project. Make sure all painting and drywall is done, doors and windows are installed and HVAC system is installed and operating.

2) ACCLIMATION: Flooring products are designed to perform in normal room conditions (NRC): ambient temperature and surface temperature must be between 65-75 degrees F, ambient relative humidity (RH) must be between 35-60%. Flooring products must achieve and maintain NRC prior to, during and after installation. Temperature readings must be taken and documented, including ambient room temperature and surface temperature. Acclimate cartons laying flat, not on end or on side, stacked no more than 5 cartons high. Avoid storing flooring in direct sunlight. Do not store on radiant in-floor heated areas.

3) INTERIOR ONLY: This product is designed for interior climate controlled areas only.

4) SUBFLOOR MOISTURE CONCRETE SUBSTRATES: Moisture levels in concrete substrates must be no higher than 85% Relative Humidity (ASTM F2170-09) and MVER of 10lbs (Calcium Chloride Test ASTM F1869-10). For levels higher than approved levels, mitigate moisture with a product designed to reduce moisture level to acceptable level. Subfloor pH must be between 5 and 9 on a pH scale. ***Note: Electronic digital moisture indicators can provide quick estimations of moisture content but do not provide qualitative readings.**

5) SUBFLOOR MOISTURE WOOD SUBSTRATES: Moisture levels in wood underlayment must not exceed 10% moisture determined by a professional electronic pin meter (example: Protimeter Surveymaster). Subfloor pH must be between 5 and 9 on a pH scale.

6) SUBFLOOR CONSTRUCTION: Subfloors must be clean, dry and free of any materials that might interfere with unrestricted movement. Subfloors must be soundly constructed to eliminate vertical movement. Subfloors must be flat, no more than 3/16" undulation in 10 linear feet or 1/8" in 6'. Subfloors must meet all Federal and local building codes. Patch subfloor depressions using a portland based patch, grind down high spots following acceptable installation standards.

***Note: For wood substrates ensure that there is a minimum of 18" between the subfloor and the ground, the crawl space is ventilated and there is a minimum 6mil poly sheeting installed over the entire ground surface overlapped and taped.**

7) PRODUCT DIRECTION: For best visual results install flooring in the same direction of direct sunlight. Use of suitable window coverings during the times with most direct sunlight is strongly recommended. Always work out of 3-5 cartons mixing products from several boxes. Always dry lay prior to final installation to ensure best visual results.

8) VISUAL INSPECTION: All flooring must be inspected, in proper lighting, prior to installation. Installed material with visible defects is not covered under the flooring warranty.

9) APPROVED SUBSTRATES: Approved substrates include: properly prepared concrete and cement leveling compounds (minimum 3500 PSI), properly prepared gypsum (minimum 3500 PSI), and underlayment grade plywood/OSB/OFB board. ***Note: Concrete substrates must be properly cured and meet moisture requirements. All concrete substrates on or below grade are required to have an approved poly film moisture barrier properly installed.**

10) RADIANT HEATED FLOORING: Flooring is only approved over hydronic (water) in floor heating. Radiant heated floors should never exceed 85 degrees Fahrenheit.

11) ADHESIVE RESIDUE: Never install over adhesive residue. Residue must be completely removed or properly encapsulated.

12) CHAIR PADS AND LEG PROTECTORS: Chair pads are required under roller castors and leg protectors. A minimum of 1.5" diameter is required under chair legs.

13) FLOOR PROTECTION: After installation floors must be protected from trade and other damage by a floor protection designed for this purpose.

Always check www.tasflooring.com for the latest installation information, warranty and maintenance information. The instructions for this product can be found by searching for Tandem Rigid. Read and follow all manufacturer instructions.

2) Installer Responsibilities

It is the floor covering installers responsibility to:

- Make sure the latest installation instructions are followed. For the most current instructions go to the manufacturer website tasflooring.com and search Tandem Rigid.
- Make sure the product is suitable for its intended use.
- Visually inspect all material and remove any visibly defective material. Visibly defective material installed will not be covered under warranty.
- Stop any project that does not meet installation guidelines and contact the flooring retailer it was purchased from.
- Work out of several boxes mixing product for visual appearance. Dry fit prior to installation is the recommended method.

3) Suitability of Product

This product is approved for climate controlled indoor applications only.

Approved for use in:

- Residential applications (exclusions- heavy rolling traffic such as hospital beds or electric wheelchairs)
- Multi-Family applications (exclusions: heavy commercial use, heavy rolling loads)
- Light Commercial applications: Light commercial is defined as light traffic commercial areas such as business offices and boutique shops. Heavier traffic areas, entry foyers, or any area where food is prepared or objects are rolled or dragged around are not recommend and not covered by this warranty.

Not approved for use in:

- Areas of heavy rolling loads (such as: hospital beds, electric wheelchairs)
- Heavy Commercial Applications
- Industrial Applications

Pease read warranty for a more complete definition of acceptable use.

4) Site Condition Requirements (NRC)

Normal Room Conditions (NRC):

Normal Room Conditions (NRC) must be maintained prior to, during and after installation. Normal room conditions are defined as:

- Ambient air temperature between 60-80 degrees Fahrenheit
- Surface temperature between 60-80 degrees Fahrenheit
- Ambient RH (Relative Humidity) between 35%-60%
- Substrate must be dry: concrete less than 80% RH (Relative Humidity), wood less than 10% moisture
- pH levels between 5 and 9
- All flooring products are required to achieve NRC prior to installation

5) Acclimation Requirements

All products must acclimate to the room conditions in which they are being installed.

Flooring products (including adhesive & trim) are designed to perform in normal room conditions (NRC). Flooring products must achieve and maintain NRC 24 hours prior to, during and 24 hours after installation. Temperature and Relative Humidity readings must be taken and documented, including ambient room temperature and surface temperature.

Acclimate cartons laying flat, not on end or on side, stacked no more than 5 cartons high. Avoid storing flooring in direct sunlight. Do not store on operational radiant in-floor heated areas. It is critical to take a surface temperature reading of the vinyl plank prior to installation. It must also be at NRC (Normal Room Conditions).

NRC (Normal Room Conditions) must be consistently maintained at:

- Room temperature between 65 and 75 degrees F
- Surface temperature between 65 and 75 degrees F
- Ambient RH (Relative Humidity) between 35% and 60%
- Flooring material must be maintained between 65 and 80 degrees F

6) Subfloor Flatness Requirements

Subfloor Flatness: Subfloor must be flat, with no undulation exceeding 3/16" in a 10' radius (or 1/8" in 6'). Grind high spots down and/or fill low spots with a quality cement patching compound. Allow patch to completely dry prior to installation. Follow patch manufacturers installation guidelines.

Follow all local building regulations and OSHA procedures when grinding. Some substrates might contain harmful contaminants; such as silica sand or asbestos. It is critical that you determine prior to grinding if there are any harmful contaminants in the subfloor.

Warning: Follow the Resilient Floor Covering Institute (RFCI rfci.com) recommended practices whenever you are grinding a substrate, existing flooring or adhesive residue. These surfaces may contain Asbestos or other harmful contaminants.

7) Subfloor Construction Requirements

Subfloor Construction must meet all Local and Federal Building Codes: Subfloors must be soundly constructed (minimum 16" on center), to eliminate vertical movement. Subfloors must be flat, not to exceed undulations exceeding 3/16" in 10' or 1/8" in 6 feet.

Approved Subfloors: It is the floor covering installers responsibility to ensure that subfloor conditions are suitable.

Substrates must meet all Federal and local building codes.

- Concrete, properly prepared concrete, cement patch & leveling, (minimum 3500 PSI). Must not exceed 85% RH (ASTM F-2170-09) and must not exceed 10lb MVFR (ASTM F1869-10). pH levels must be between 5 and 9.
- Gypsum, properly prepared gypsum (minimum 3500 PSI). Must be dry based on gypsum and adhesive manufacturer standards, maximum 85% RH (ASTM F2170-09).
- Underlayment grade plywood. Must be minimum 1" total thickness, must be dry, less than 10% moisture content.
- Underlayment grade Orientated Strand Board (OSB) and Orientated Fiber Board (OFB), minimum 1" thickness.

Non-Approved Subfloors: It is the floor covering installers responsibility to ensure that subfloor conditions are suitable. Substrates must meet all Federal and local building codes.

- Sleeper type floor systems
- Plywood installed directly over a concrete slab
- Soft plywood or plywood not approved as "Underlayment Grade" certified by the Plywood Association, Luan, and pressure treated.
- Masonite or hardboard
- Contaminated surfaces: abatement chemicals, paint, oil, mold, mildew, grease or any containments that might interfere with adhesive bonding
- Strip plank wood flooring
- Uneven (3/16" in 10') or unstable substrates

For all substrates not mentioned check with TAS Flooring before proceeding with the installation.

On Grade and Below Grade Substrates: Below grade substrates require a 6mil polyethylene film be applied to the substrate or a permeant moisture mitigation product must be applied. On grade substrates where moisture exceeds 85% RH must have a 6mil polyethylene film applied.

8) Radiant Heated Floors

Radiant Heated Substrates: In-Floor hydronic (water) radiant heat is acceptable to install over providing the substrate never exceeds 85 degrees Fahrenheit. In-Floor radiant heated floors must be turned off to achieve a substrate temperature between 65 and 75 degrees Fahrenheit prior to, during and for 48 hours after the installation.

- Floor warming systems, such as electric wire and mat systems, are not approved to install over.

9) Layout

- It is best to lay flooring parallel to light source (such as a window).
- Determine the center of the room by marking the center of each end wall. Snap a chalk line between these two points.
- Dry lay rows to wall. If the plank to the long wall will be less than 2" adjust the center line to make the long wall plank over 2". The goal is to have planks next to the wall to be a minimum of 2". Balance the cuts in the room.
- Stagger end joints by a minimum of 8" on a random basis.

10) Expansion Space and Transition Trim

Expansion Space:

Flooring expands and contracts with normal climate changes. This product must be allowed to freely float, to expand and contract monolithically.

- At vertical surfaces that will be covered with wall base allow a minimum 1/4" expansion gap, with minimum 1/4" gap coverage.
- Undercut door jambs and other vertical surfaces to allow flooring to freely fit underneath.
- At vertical surfaces that will not be receiving wall base or other expansion trim (such as sliding glass doors); allow a minimum 1/4" expansion gap and caulk gap with a flexible caulking (Silicone).
- Do not fit flooring full or under compression.

Expansion Transition Trim:

Transition trim must be used:

- In areas exceeding 6,400 square feet
- Between areas of uneven heating, where one areas temperature might be maintained differently than an adjoining area.
- At doorways and sliding glass doorways, use an end cap square edge transition.
- Transition trim is not required at interior doorways if all other expansion space requirements are met. A minimum 1/4" expansion gap must be maintained around door casing, or casing may be undercut to provide the 1/4" minimum expansion space.

11) Trim



End Cap

Use at sliding glass doors, entry doors, fireplaces, carpet, etc.



T-Mold

Use between two products close in height.



Reducer

Use when transitioning to hard surface.

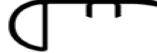

Stair Nose

Use at stair nose.



Quarter Round

Use at wall base to extend coverage.

12) Installing on Stairs

- When installing on stairs, a stair nosing must be used.
- When adhering flooring to stairs use a permanent bonding adhesive, such as: urethane adhesive or solvent-free construction adhesive.

13) Installation Instructions

STARTING YOUR INSTALLATION

- Work from several open boxes of flooring and "dry lay" the floor before permanently laying the floor. This will allow you to select the varying grains & colors and to arrange them in a harmonious pattern. Remember, it is the installers' responsibility to determine the expectations of what the finished floor will look like with the end user first and then to cull out pieces that do not meet those expectations.
- Begin installation next to an outside wall. This is usually the straightest and best reference for establishing a straight working line. Establish this line by measuring an equal distance from the wall at both ends and snapping a chalk line. The distance you measure from the wall should be the width of a plank. You may need to scribe cut the first row of planks to match the wall in order to make a straight working line if the wall is out of straight.
- You may want to position a few rows before starting installation to confirm your layout decision and working line. When laying flooring, stagger end joints from row to row by at least 8". When cutting the last plank in a row to fit, you can use the cut-off end to begin the next row. If cut-off end is 8" in length or less, discard it and instead cut a new plank at a random length and use it to start the next row. Always begin each row from the same side of the room. When near a wall, you can use a pry bar to pry close the side and end joints.

INSTALLATION INSTRUCTIONS Inspection: Prior to installation, inspect planks in daylight for visible faults/damage. Check if subfloor/site conditions comply with the specifications described in these instructions. If you are not satisfied, do not install, and contact your supplier. Before laying: Measure the room at right angle to the direction of the planks. For best visual effect, planks in the final row should be at least 2 inches wide (half width of plank minimum). For this purpose, planks in the first row can be cut to smaller size. Shuffle planks in order to obtain a pleasant blend of shades. Lay planks preferably following the direction of the main source of light. We recommend laying on wooden floors crossways to the existing floorboard. Planks must not be nailed or screwed to the subfloor. Base boards and molding must not be fixed in a way which restricts the movement of the floor. *Do not restrict movement of the floor by placing heavy objects like kitchen islands or cabinets onto the flooring.

INSTALLING THE FIRST ROW

1. Adjust row so end cut is not less than 8".
2. Use spacers to allow 1/4" expansion gap between the planks and the walls, or stationary interior room objects, so there is room for normal expansion and movement.
3. Starting from the left with the tongue facing the wall, carefully place the first board in place. Figure 1.
4. Engage the end joint of the second plank into the end joint of the first plank at a 45° angle. The board must be flat to engage completely. If necessary, tap lightly into place by using a rubber mallet and tapping block made from a trimmed piece of flooring to firmly lock short end. Continue in this manner until reaching the final plank in the first row.
5. Cut the final board piece to length.
6. Begin the second row with the cut piece from the first row. If the cut piece is shorter than 8", do not use it. Instead, begin with a new board that is at least 8" in length and allow 8" between the end joints on the adjacent planks. Figure 2.
7. Position the first board of the second row in place by angling it up slightly, pushing forward and interlocking the long side of the plank.
8. Install second board of the second row (same as step 7 above). Angle second board close to end joint of first board. Ensure board lays flat. Figure 3.
9. Before moving on to the next board, ensure the end and long joints are flush and tight.
10. Install the remaining boards and rows in the same manner. Figures 4 & 5.
11. Cut the last board to size. If necessary, complete the tight fit by tapping the board into place with a pull bar.
12. Whenever practical, use cut pieces from previous rows as the starter board to reduce waste. Pieces must be a minimum of 8".
13. Maintain 8" spacing between end joints after the first four rows for best appearance.

INSTALLING UNDER A DOOR JAMB

1. Installation under moldings (such as door jambs) may require that the top lip of the groove on the end be reduced in size.
2. Using a small plane or knife plane, carefully shave off the ledge of the groove. Figure 6.
3. After the groove ledge has been trimmed, place the board in place and tighten with a pull bar to test for fit. The installer must be sure that the required expansion gap has been maintained and the flooring is not pinched.
4. If fit is not correct, re-trim as necessary.
5. Place a bead of wood glue on the bottom lip of the groove.
6. Insert the tongue into the groove and tighten the fit with a pull bar. Hold the board in place with Blue painters tape.

INSTALLING FINAL ROW

1. The last row may need to be cut lengthwise (ripped).
2. When measuring to rip, be sure to consider the expansion gap. Some walls may not be straight.
3. After the boards are cut, position planks and tighten the fit using the pull bar.

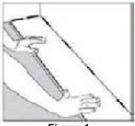

Figure 1

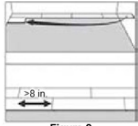

Figure 2

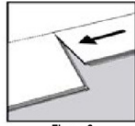

Figure 3

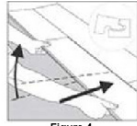

Figure 4



Figure 5



Figure 6

14) Floor Protection

Floor Protection:

- Allow adhesive to set up before allowing traffic onto the installation: light traffic 24 hours, heavy traffic 72 hours.
- If other trades are working in the installation area, protect flooring with an approved breathable floor protection material such as a builder board or reinforced 60lb Kraft paper.
- Wait a minimum of 24 hours before applying floor protection.
- Always use chair pads under rolling castor chairs and chair leg protectors, minimum of 1-1/2" diameter, under furniture legs.

15) Maintenance

Initial Maintenance

Always use a neutral pH cleaner, such as WF Taylor Fresh Floors.
Allow flooring to dry completely prior to foot traffic.

Daily & Weekly Maintenance

Sweep, dust mop or vacuum the floor as needed to remove loose dirt and grit. Do not use a vacuum with bristles or a beater bar.
Clean liquid spills immediately.
Damp mop (do not flood floor) as needed

Preventative Maintenance

Chair pads are required under roller castor chairs.
Furniture leg protectors, minimum 1.5" diameter, are required under all furniture legs.
Use protective boards when sliding heavy furniture across flooring.
Never apply rubber mats directly on top of vinyl flooring.
Place walk off mats outside entry doors to prevent dirt and sand from entering into the installation.
Protect flooring from direct sunlight with window and glass door coverings to prevent fading.
Any additional floor finishes are not required and not approved. The application of any additional floor finishes without written consent from TAS Flooring will void all warranties.



PLEASE READ ALL INSTRUCTIONS CAREFULLY, BEFORE YOU BEGIN INSTALLATION.
IMPROPER INSTALLATION WILL VOID WARRANTY. FOR ALL INSTALLATION CONDITIONS AND INFORMATION NOT COVERED SPECIFICALLY UNDER THESE INSTRUCTIONS, OR
DEFECTIVE MATERIAL, CONTACT TAS FLOORING.